

060R9304

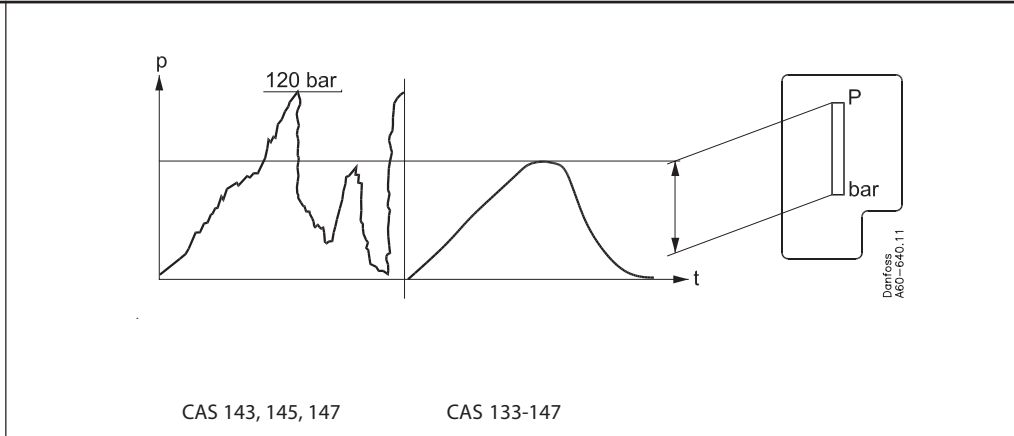
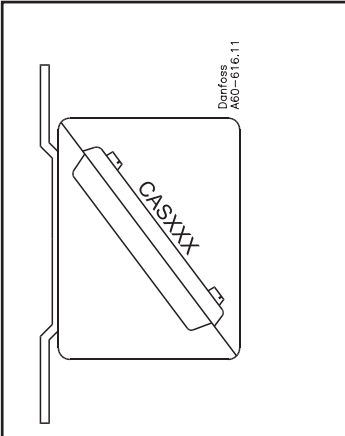

060R9304

Danfoss
AG0-656.12

	T ₁ min. (°C)	T ₂ min. (°C)	T ₁ max. (°C)	T ₂ max. (°C)
CAS 133, 136, 137, 139	-40	-40	70	100
CAS 143, 145, 147*	-25	-25		

*T₂ max. woda/water/Wasser/eau: 80°C

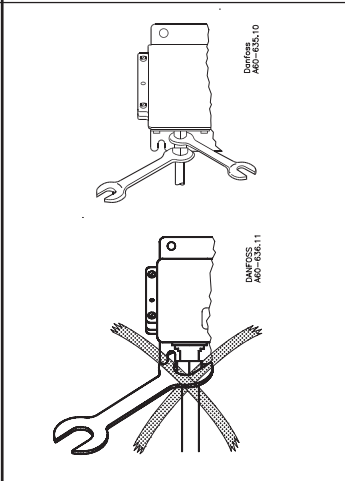
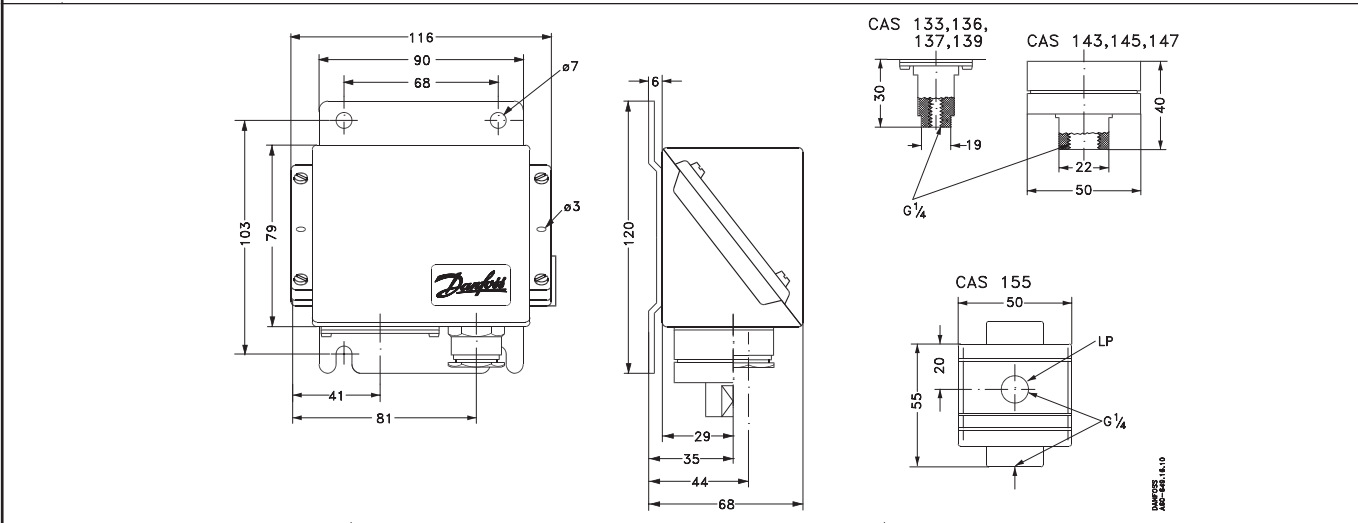

Danfoss
AG0-637.11

	P _{max} bar
CAS 133	10
CAS 136	22
CAS 137	27
CAS 139	45
CAS 143	180
CAS 145	180
CAS 147	180

Danfoss
AG0-641.12

TEST RANGE DIFF: bar

AG 11 0.1A 250V ~
DC 11 12V 125V

bar Pe bar Pe

1 2 4

CAS MADE IN DENMARK

DIFF: bar

AG0-641.12

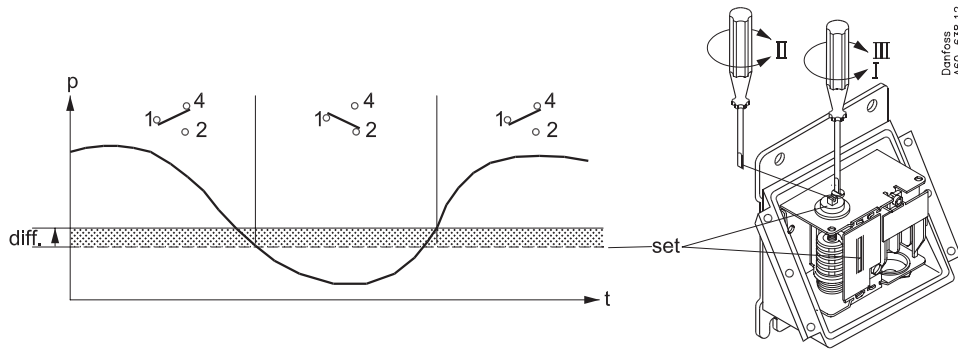

Danfoss
A60-63B.12

	Mech. różn. zał. Diff. (bar)
CAS 133	0.1
CAS 136	0.2
CAS 137	0.3
CAS 139	0.6
CAS 143	0.2 - 0.6
CAS 145	0.8 - 2.4
CAS 147	1.0 - 3.0

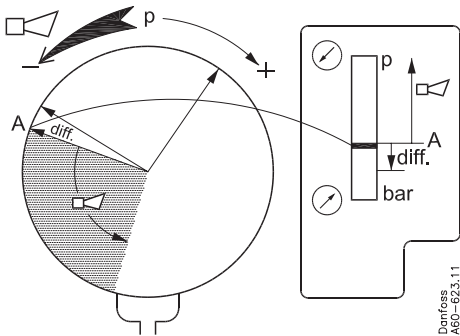

Danfoss
A60-623.11

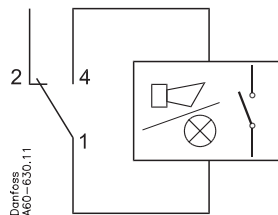

Danfoss
A60-630.11

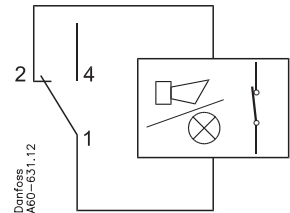

Danfoss
A60-631.12

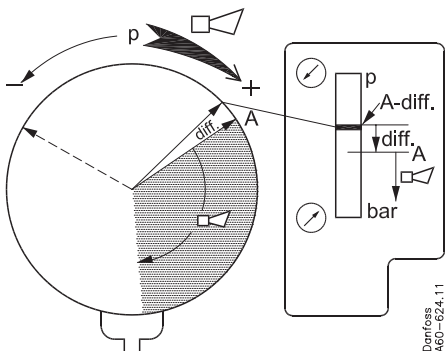

Danfoss
A60-624.11

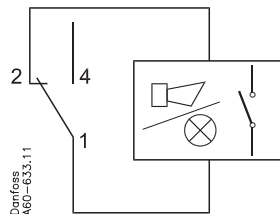

Danfoss
A60-633.11

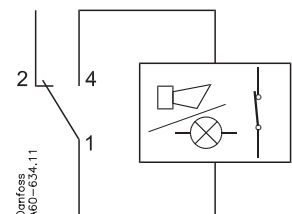

Danfoss
A60-634.11