

Spare parts and accessories for ICM 20-65		Description	Qty.	Code No.
	<b>ICM 20</b>			
	<b>Top cover / Function module, fig. 1</b> (including gasket and O-rings)			
	Pos. 2	ICM 20-A	1	027H1180
	Pos. 2	ICM 20-B	1	027H1181
	Pos. 2	ICM 20-C	1	027H1182
	<b>ICM 25</b>			
	<b>Top cover / Function module, fig. 1</b> (including gasket and O-rings)			
	Pos. 2	ICM 25-A		027H2180
	Pos. 2	ICM 25-B		027H2181
	<b>ICM 32</b>			
<b>Top cover / Function module, fig. 1</b> (including gasket and O-rings)				
Pos. 2	ICM 32-A	1	027H3180	
Pos. 2	ICM 32-B	1	027H3181	
<b>ICM 40</b>				
<b>Top cover / Function module, fig. 1</b> (including gasket and O-rings)				
Pos. 2	ICM 40-A	1	027H4180	
Pos. 2	ICM 40-B	1	027H4181	
<b>ICM 50</b>				
<b>Top cover / Function module, fig. 1</b> (including gasket and O-rings)				
Pos. 2	ICM 50-A	1	027H5180	
Pos. 2	ICM 50-B	1	027H5181	
<b>ICM 65</b>				
<b>Top cover / Function module, fig. 1</b> (including gasket and O-rings)				
Pos. 2	ICM 65-B	1	027H6181	
<b>Actuator, fig 1</b>				
Pos. 11	ICAD 600 for ICM 20		027H1200	
Pos. 11	ICAD 600 for ICM 25		027H1200	
Pos. 11	ICAD 600 for ICM 32		027H1200	
Pos. 11	ICAD 900 for ICM 40		027H1201	
Pos. 11	ICAD 900 for ICM 50		027H1201	
Pos. 11	ICAD 900 for ICM 65		027H1201	
<b>Disassembly kit, fig. 1</b>				
Pos. 3a, 3b, 4	ICM 20	1	027H1190	
Pos. 3a, 3b, 4	ICM 25	1	027H2220	
Pos. 3a, 3b, 4	ICM 32	1	027H3220	
Pos. 3a, 3b, 4	ICM 40	1	027H4220	
Pos. 3a, 3b, 4	ICM 50	1	027H5220	
Pos. 3a, 3b, 4	ICM 65	1	027H6220	
<b>Blank top cover</b>				
fig. 2	ICM 20		027H1174	
fig. 2	ICM 25		027H2174	
fig. 2	ICM 32		027H3174	
fig. 3	ICM 40		027H4174	
fig. 3	ICM 50		027H5174	
fig. 3	ICM 65		027H6174	
<b>Manual magnet tool, fig. 4</b>				
	MMT for ICM 20, 25, 32		027H0180	
	MMT for ICM 40, 50, 65		027H0181	

Pos. 1 - valve body can be ordered separately (see ICM technical leaflet RD4YB)

Fig. 1

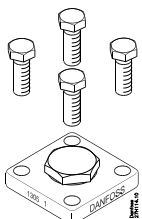

Fig. 2 - Blank top cover ICM 20

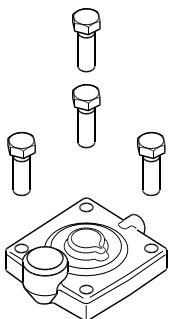

Fig. 3 - Blank top cover ICM 25-65



Fig. 4 - Manual magnet tool